

REV.	LOCAS.	DESCRIPTION	DATE	DRAWN
01	NEW	INITIAL RELEASE.	2010.12.27	李春

Recommended P.C.Board Layout

(Tolerance: ±0.05)

Specifications

Current Rating: 1Amp
 Insulation Resistance: 1000MΩ Min.
 Dielectric Withstanding: 300V AC/DC
 Contact Resistance: 20mΩ Max.
 Operating Temperature: -40°C to +105°C

Materials

Contact Material: Brass
 Insulation Material: Polyester, UL 94V-0

LCP
 All materials must meet Greenconn
 requirement for environment protection

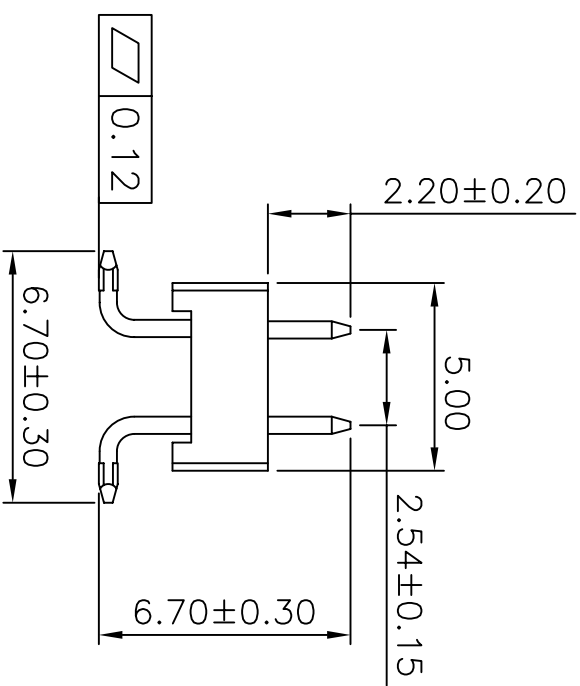
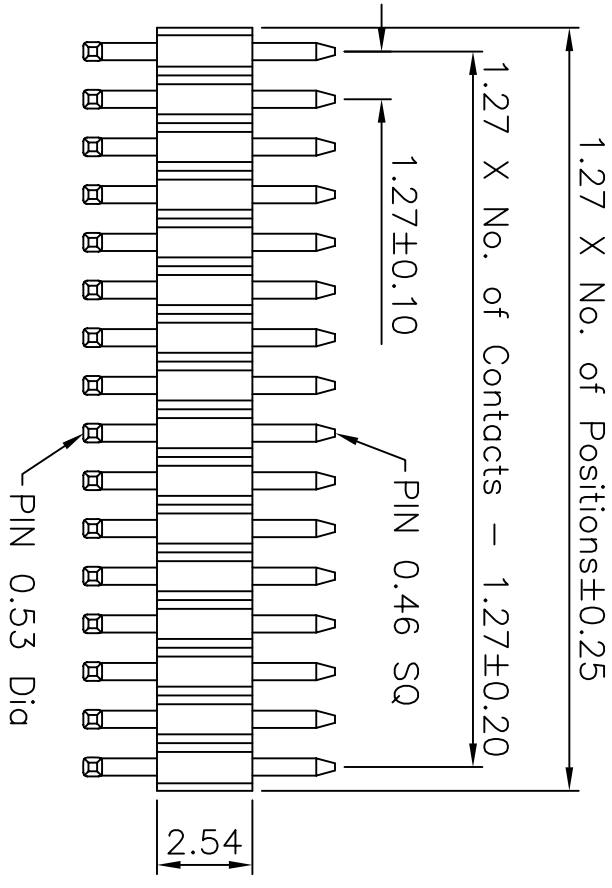
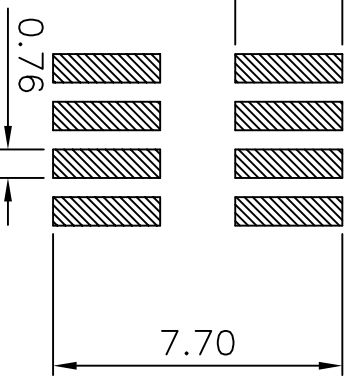
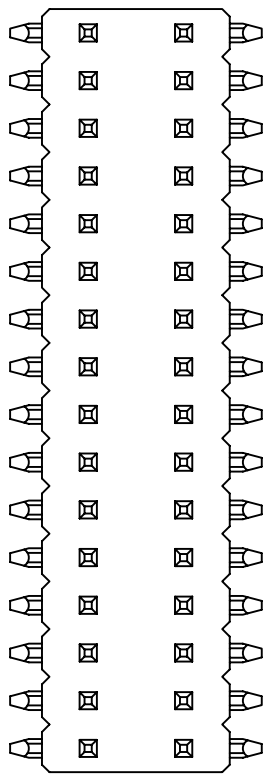

CNT 肯耐特电子有限公司

REV. 01	UNIT. mm	SCALE. 1:1	PAGE. 1/1	
---------	----------	------------	-----------	--

GENERAL TOLERANCE

X' ± 5.0°	X ± 0.30
X' ± 3.0°	X ± 0.25
.XX' ± 2.0°	.XX ± 0.20
.XXX' ± 1.0°	.XXX ± 0.10

DESIGN: 李春 DATE: 2010.12.27

CHECKED: DATE:

APPROVED: DATE:

DWG. NO.

PART NO. CTN-M127*254-2*XX-0M-2.2/4.5/6.7/

TITLE:

1.27 PIN HEADER
 DUAL ROWS SMT TYPE
 BASE 2.54H