

ROHS

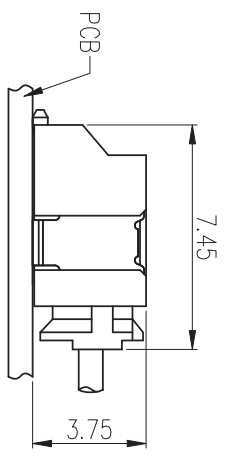
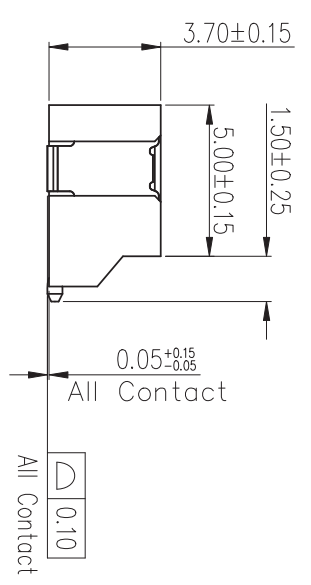
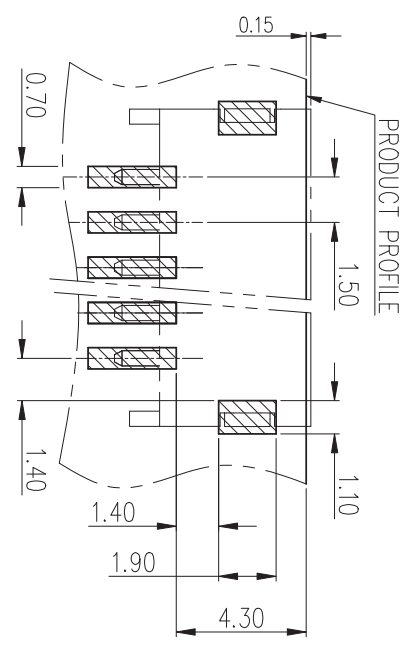
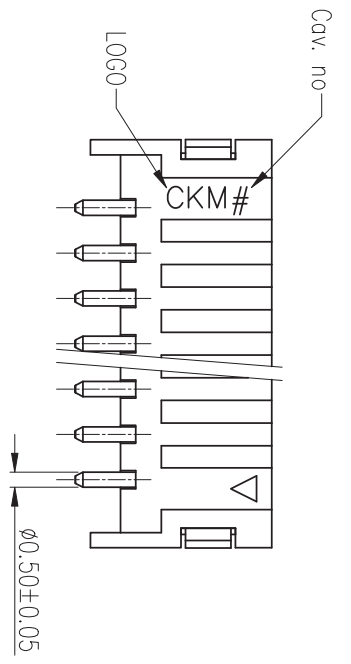
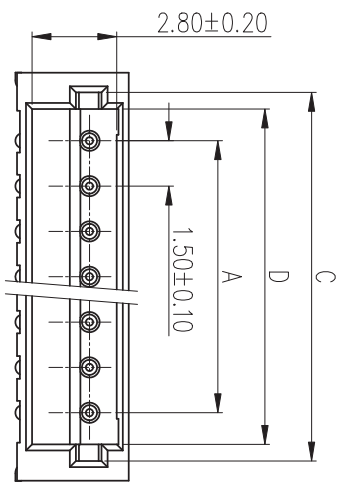
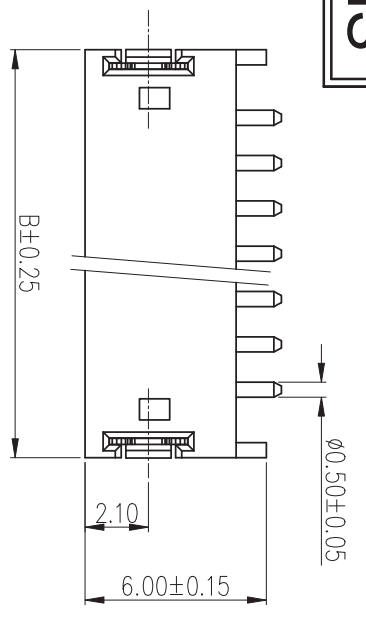

POS	A	B	C	D
2	6.00	4.70	3.60	
3	3.00	7.50	6.20	5.10
4	4.50	9.00	7.70	6.60
5	6.00	10.50	9.20	8.10
6	7.50	12.00	10.70	9.60
7	9.00	13.50	12.20	11.10
8	10.50	15.00	13.70	12.60
9	12.00	16.50	15.20	14.10
10	13.50	18.00	16.70	15.60
11	15.00	19.50	18.20	17.10
12	16.50	21.00	19.70	18.60
13	18.00	22.50	21.20	20.10
14	19.50	24.00	22.70	21.60
15	21.00	25.50	24.20	23.10

NOTE:

- MATERIAL SPECIFICATION
1.1.HSG: THERMOPLASTIC U194V-0.
1.2.PIN: COPPER ALLOY.
1.3.PEG: THICK 0.20mm COPPER ALLOY.
- PLATING SPECIFICATION
2.1.PIN: MATTE TIN PLATED.
2.2.PEG: BRIGHT TIN PLATED.
- BILL OF PART NO:

1501WRS-XP-XX
 COLOR: BLANK(NATURAL) OR A~Z
 FINISH: A=MATTE TIN PLATING.

- NO OF CIRCUITS: 2~15
- FOR COLOR, AVAILABILITY, DELIVERY & MOQ
- DIMENSIONAL

D	UPGRADE DRAWING	Rock	2016.01.27
C	UPGRADE LOGO POSITION	Rock	2011.11.30
REV.	ECN NO	REVISION RECORD	DRAW DATE

TOLERANCE		UNIT:
X.XXX ±0.10	X.XXX ±0.10	mm
X.X ±0.30	Angular ±2°	
X.XX ±0.20		

PART NO.	1501WRS-XP-XX	DRAWING NO.	C-15010203-XX	APPROVED BY	CHECKED BY	DRAWN BY	PAGE	REV.
DRAWING NO.	C-15010203-XX							
DESCRIPTION				RIGHT ANGLE SMT TYPE		SCALE		D
C N T 肯耐特电子有限公司				WTB 1501 SERIES 1.5mm PITCH		1 OF 1		
Customer Drawing				2016.01.27		4 : 1		